

SYSTEM H-B PRO

Treatment Unit TU H-B 360

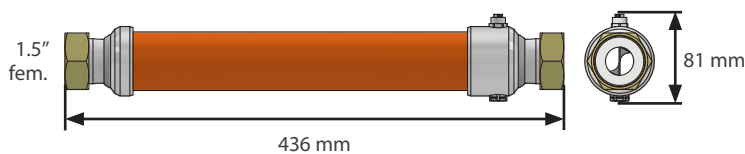

Treatment Unit TU H-B 60



Control Unit CU H PRO

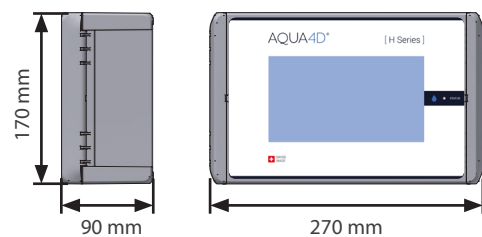

Control Unit (CU)

The CU H Pro control unit transmits signals to the treatment units (TU) and continuously monitors system operation.

4 outputs available

Each control unit can drive up to 4 treatment units.

Alarm management

Constant checking of component operation and notification of any problems.

Remote monitoring

Live communication of CU H Pro information and status via LTE-M mobile network (4G or higher), antenna and SIM card included.

Treatment Unit (TU)

Device for broadcasting the signals generated by the CU H Pro control unit. Water contact surface in PVC-C, certified for drinking water.

TU H-B 60

Treatment unit for lower flow rates, up to 60L/min.

TU H-B 360

Treatment unit for high flow rates, guaranteed treatment up to 360L/min.

Modularity

Depending on the total water flow to be treated, the H-B Pro system can combine several treatment units to achieve the desired value. This requires parallel installation (see *installation instructions* on next page).

Connectivity

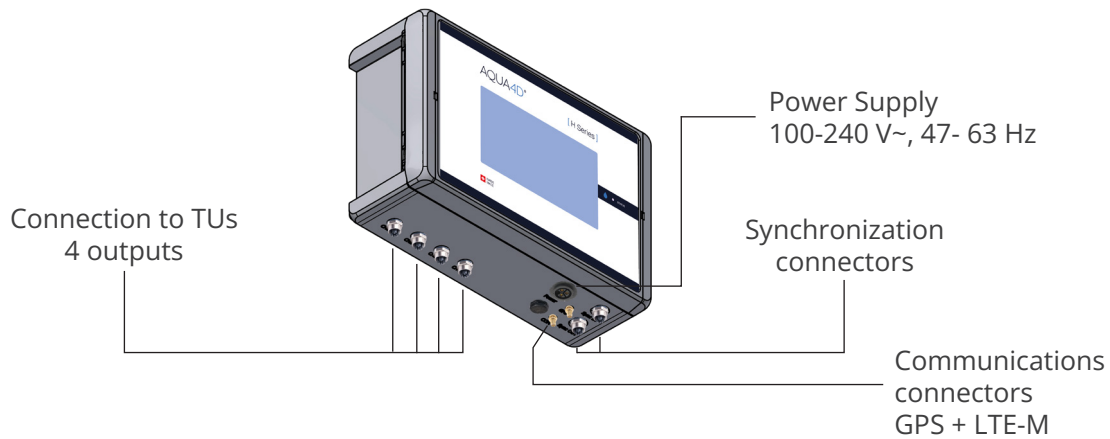

Installation instructions

- The positioning of TUs in the water system must comply with current regulations. Consult applicable standards or a sanitary fitter.
- TUs must be installed in the system so that the arrow points in the direction of water flow.
- TUs can be installed horizontally or vertically.
- Several TUs can be installed in parallel:
 - The minimum distance between 2 TU 60 is 100 mm, measured from the center of one axis to the other.
 - The minimum distance between 2 TU 360 is 160 mm, measured from the center of one axis to the other.
- TU 60 and TU 360 treatment units must not be installed in parallel on the same pipe.

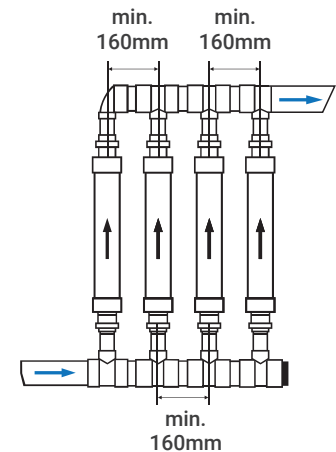

TU H-B 360
Installation example

Warning !

AQUA4D® TUs must not be subjected to excessive mechanical stress (tension or torque) during installation.

System designation

Depending on the configuration installed, AQUA4D® systems are designated as follows:

Example: AQUA4D® H-B Pro 1 1

System configuration for buildings (B) comprising 1x TU H-B 360 + 1x TU H-B 60

AQUA4D® H-B Pro 1 1

1st letter	2nd letter	1st number	2nd number
Product generation	Application A = Agriculture B = Building	Quantity of TU 360 1 to 4 units	Quantity of TU 60 1 to 4 units

Accessories

SYNCHRONIZATION CABLES

Necessary for synchronizing several CU H Pro units with each other.

Cables made to measure only. Please contact us for a quotation.

info@aqua4d.com

CONNECTION CABLES FOR TU H-B

For TU H-B 360 or TU H-B 60

- 5 m cable Art. n° ELCO2223
- 10 m cable Art. n° ELCO2224
- 20 m cable Art. n° ELCO2225



Configurations

System	CU H Pro quantity	TU H-B 360 quantity	TU H-B 60 quantity	Article n°	Water flow (L/m)	Water flow (m3/h)	Weight (kg)	Power [W]
AQUA4D® H-B Pro 01	1	0	1	9001012	60	3.6	4	8
AQUA4D® H-B Pro 02	1	0	2	9002012	120	7.2	6	10
AQUA4D® H-B Pro 03	1	0	3	9003012	180	10.8	8	13
AQUA4D® H-B Pro 04	1	0	4	9004012	240	14.4	10	16
AQUA4D® H-B Pro 10	1	1	0	9010012	360	21.6	9	10
AQUA4D® H-B Pro 11	1	1	1	9011012	360 60	21.6 3.6	12	13
AQUA4D® H-B Pro 12	1	1	2	9012012	360 120	21.6 7.2	14	16
AQUA4D® H-B Pro 20	1	2	0	9020012	720	43.2	16	15
AQUA4D® H-B Pro 21	1	2	1	9021012	720 60	43.2 3.6	18	18
AQUA4D® H-B Pro 22	1	2	2	9022012	720 120	43.2 7.2	20	21
AQUA4D® H-B Pro 30	1	3	0	9030012	1080	64.8	24	20
AQUA4D® H-B Pro 40	1	4	0	9040012	1440	86.4	31	25

Technical data

CU H Pro

Mechanical specs	
Dimensions	270 x 170 x 90 mm
Weight	1.4 kg
Housing material	Polycarbonate
TU Connectors	Amphenol M12-X series 8-pole, female
Power connector	Amphenol PWC 3-pole, 20A
Pressure compensator	M12 - IP68
Communication antenna	GPS and LTE-M, molded cable
Antenna connectors	RF Cables SMA Gold Jack (fem)

Power supply	
Supply voltage	100 ... 240 V~, 47 ... 63 Hz
Power consumption	max. 25 W

Ambient conditions	
Protection class	IP 65
Ambient temperature	0 ... 40 °C
Storage temperature	-25 ... 60 °C
Electromagnetic compatibility	Emissivity and immunity in compliance with IEC 61000-6-1 and IEC 61000- 6-3 standards
Overvoltage protection	In accordance with IEC 61000-4-5
Relative humidity	0 ... 95%, non-condensing

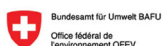

AQUA4D®

- by Planet Horizons Technologies SA -

Planet Horizons Technologies SA

Ecoparc de Daval A9
3960 Sierre
Switzerland
T +41 27 480 30 35
info@aqua4d.com
www.aqua4d.com

TU H-B 360 et TU H-B 60

Mechanical specs TU H-B 360	
Length (without gaskets)	804 mm
Max. diameter	113 mm
Connection	Threaded nut 2" 3/4, female
Adapters supplied	Brass 2"3/4 to 2" female screw-in
Passage diameter	2" (DN 50)
Weight	7 kg
Cable length	200 cm
Connectors	Amphenol M12-X series 8-pole, female
Maximum flow	360 L/min, 21.6 m3/h, 95.1 US gpm
Material	PVC-C, approved for drinking water
Nominal pressure	PN16

Mechanical specs TU H-B 60	
Length (without gaskets)	436 mm
Max. diameter	81 mm
Connection	Threaded nut 1.5", female
Adapters supplied	Brass 1.5" to 1" female screw-in
Passage diameter	1" (DN 25)
Weight	1.8 kg
Cable length	200 cm
Connectors	Amphenol M12-X series 8-pole, female
Maximum flow	60 L/min, 3.6 m3/h, 15.8 US gpm
Material	PVC-C, approved for drinking water
Nominal pressure	PN16

Environmental conditions	
Protection class	IP 65
Ambient temperature	0 ... 60 °C
Storage temperature	0 ... 70 °C
Installation temperature	10 ... 50 °C

Water temperature	Max pressure
20°C	16 bar
60°C	7.5 bar
80°C	4 bar